



BEST IN GAMES, SAUNAS,
POOL AND PATIO

SLAPSHOT

84" AIR HOCKEY TABLE
RA1000



FREETIME FUN
1830 E. FABYAN PKWY.
BATAVIA, IL 60510
WWW.FREETIMEFUN.COM

Check all packaging before discarding.

Be sure all parts identified in the assembly manual are included.

Don't assemble if parts are missing.

If you are missing parts or have questions please contact our toll free line at 1-888-620-6088.

Thank you for purchasing this product. If you experience any issues during assembly or use of this product, please don't hesitate to contact Customer Service at **1-888-620-6088** for immediate assistance.

ASSEMBLY TIPS

IMPORTANT! PLEASE READ THESE ASSEMBLY INSTRUCTIONS IN ENTIRETY BEFORE ASSEMBLING YOUR PRODUCT.

Estimated Assembly Time: 40 minutes.

1. Find a clean, level surface to begin the assembly of your game table. Assembly will require two adults. You may want to carefully cut the four corners of the box so that the bottom of the box can be used as your work surface.
2. Remove all of the contents from the box and verify that you have all of the parts shown on the Parts List before you begin assembly. **Note: Some parts are pre-installed or pre-assembled.**
3. **When installing parts that have more than one screw or bolt, hand tighten all screws or bolts in place before final tightening with screwdriver or wrench.**
4. Electric screwdrivers may be helpful during assembly; however, please set a low torque and use extreme caution because screws may be stripped if overtightened, resulting in damaged parts.

► **THIS PRODUCT IS INTENDED FOR INDOOR USE ONLY.**
DO NOT DRAG THE TABLE WHEN MOVING IT AS THIS MAY CAUSE DAMAGE TO THE LEGS.

ACCESSORIES

10



Striker
XRA10009 (4)

11



Puck
XRA10010 (4)

HARDWARE PACK

XRA10011 (1)

12

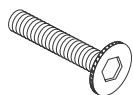

5/16" x 1-1/4" Bolt (16)

13

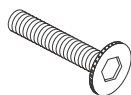

5/16" x 3-3/8" Bolt (12)

14

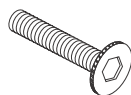

5/16" x 2-3/4" Bolt (8)

15



5/16" Washer (36)

16



Dome Head Screw
1/2" (4)

17



Allen Wrench (1)

18

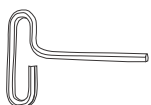

Allen Wrench
with Handle (1)

SLAPSHOT 84" AIR HOCKEY TABLE ASSEMBLY INSTRUCTIONS

PARTS LIST

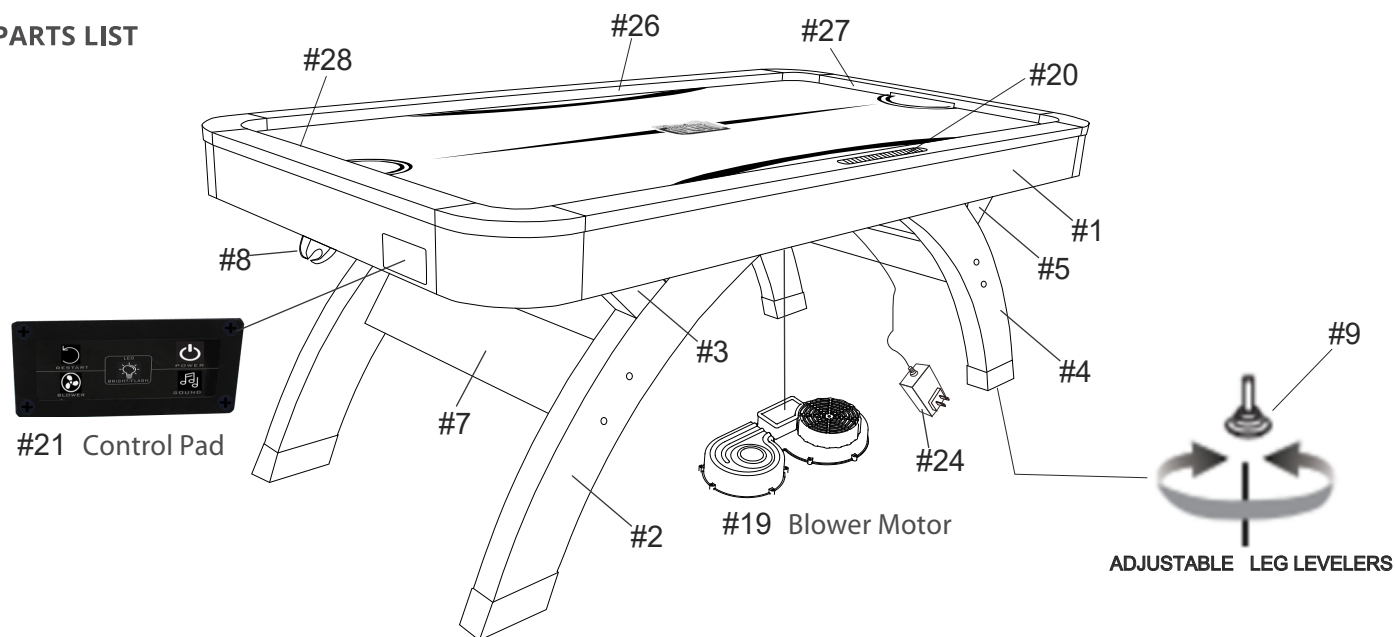
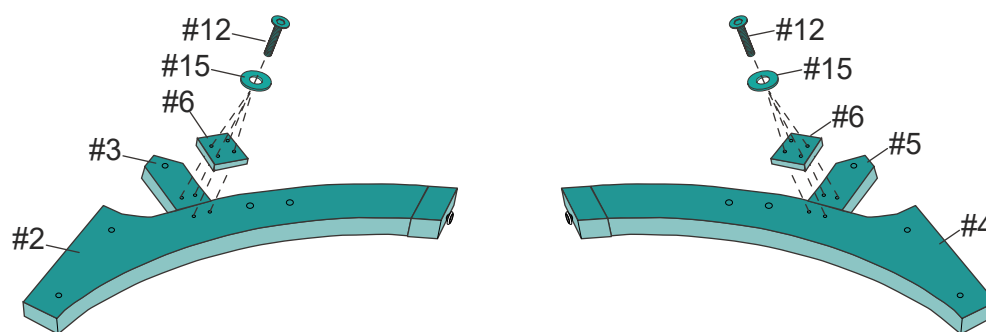

TABLE PARTS

1 (Pre-assembled) Table Cabinet XRA10000 (1)	2 Left Main Leg XRA10001 (2)	3 Left Leg Upright XRA10002 (2)	4 Right Main Leg XRA10003 (2)	5 Right Leg Upright XRA10004 (2)
6 Leg Connection Plate XRA10005 (4)	7 Leg End Panel XRA10006 (2)	8 Puck Goal Catcher XRA10005 (2)	9 (Pre-assembled) Leg Leveler XRA10008(4)	19 (Pre-installed) Blower Motor XRA10012 (1)
20 (Pre-installed) Electronic Scorer XRA10013 (1)	21 (Pre-installed) Control Pad XRA10014 (1)	22 (Pre-installed) Scorer Sensor Assembly XRA10015 (2)	24 Power Box Adaptor XRA10017 (1)	25 (Pre-installed) Power Box XRA10018 (1)
26 (Pre-installed) Long LED Light Bar XRA10019 (2)	27 (Pre-installed) Left Short LED Light Bar XRA10020 (2)	28 (Pre-installed) Right Short LED Light Bar XRA10021 (2)		

SLAPSHOT 84" AIR HOCKEY TABLE ASSEMBLY INSTRUCTIONS

STEP 1



STEP 2

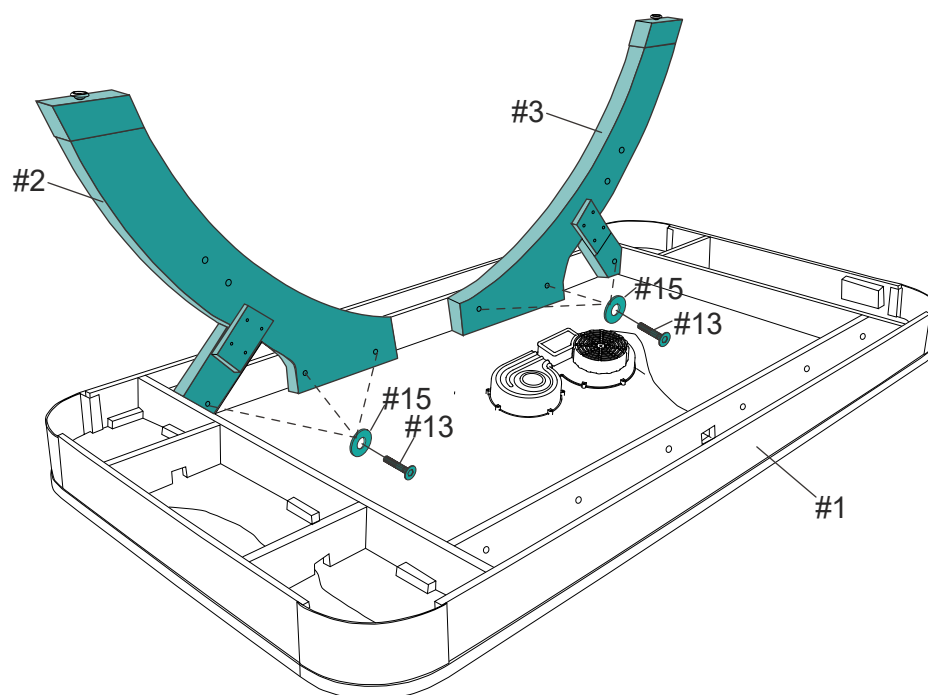

STEP 3

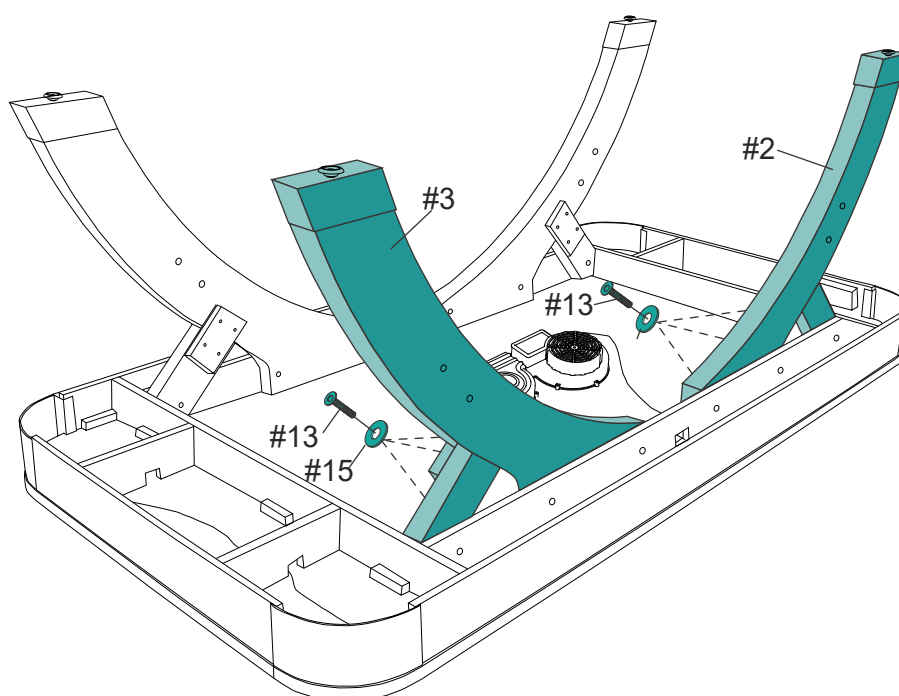

SLAPSHOT 84" AIR HOCKEY TABLE ASSEMBLY INSTRUCTIONS

STEP 4

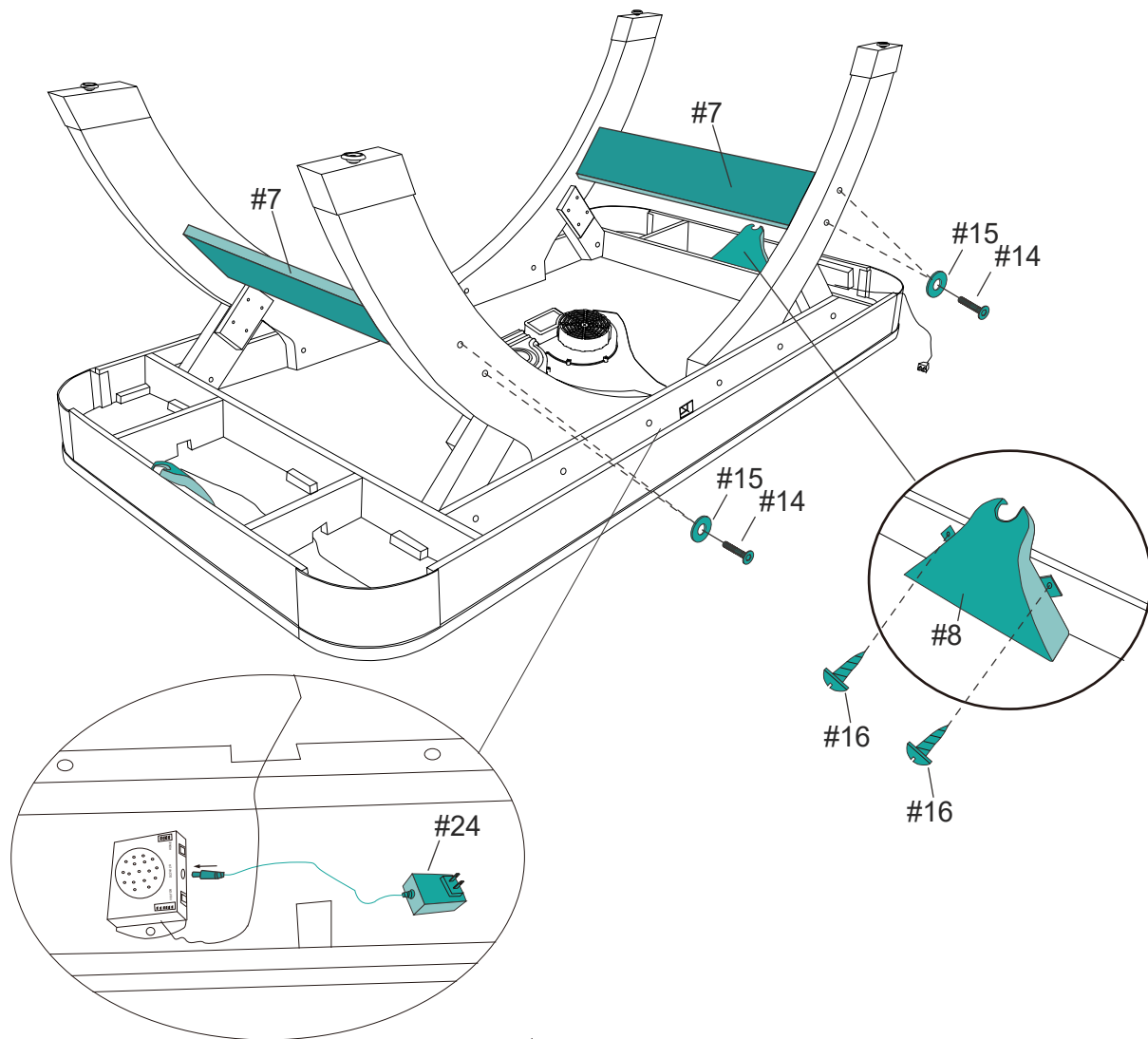

STEP 5

CAUTION: THE TABLE IS HEAVY; IT IS RECOMMENDED THAT FOUR STRONG ADULTS ASSIST IN FLIPPING THE TABLE OVER TO THE UPRIGHT POSITION AS SHOWN BELOW.

HOLD TABLE CORNER

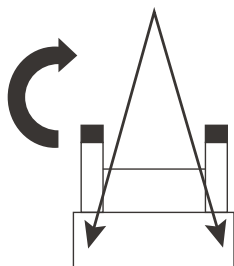

Firmly grasp the table at each cabinet corner area

CABINET

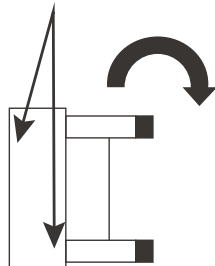

Carefully rotate the table to the upright position by grasping table top

DO NOT LEAN THE TABLE ON ITS LEGS!

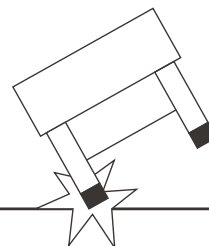

Position the table in its desired location and level the table to the floor by adjusting the leg levelers

DO NOT HOLD THE LEGS

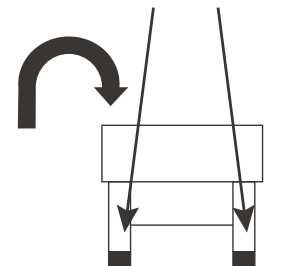

SLAPSHOT 84" AIR HOCKEY TABLE ASSEMBLY INSTRUCTIONS

STEP 6

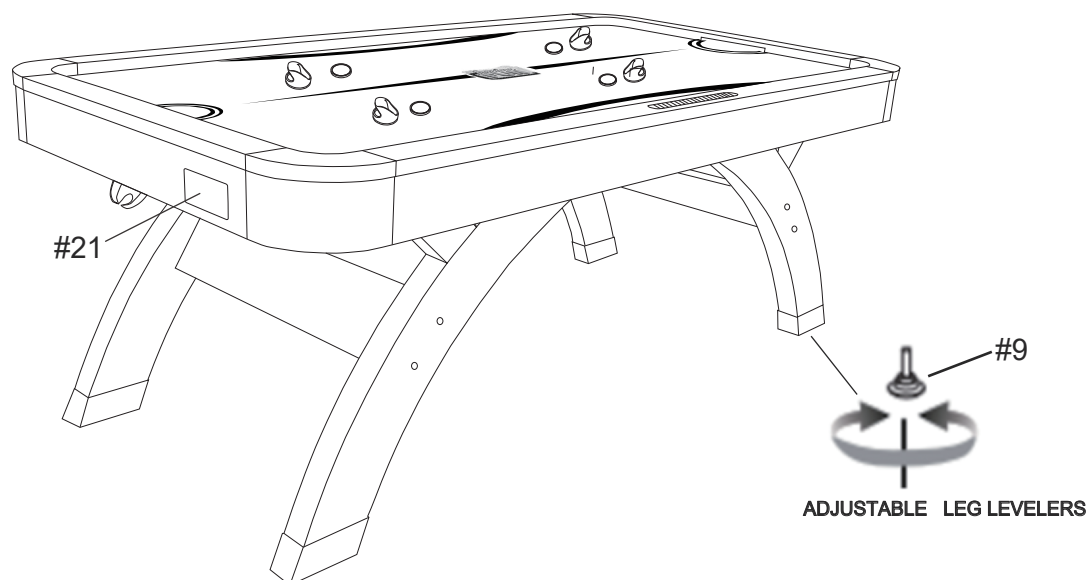

Position the table in its desired location and level the table to the floor by adjusting the leg levelers

STEP 7



Control Pad Functions



A) POWER

Press the POWER button to turn the game table ON / OFF.



B) BRIGHT / FLASH

Press the BRIGHT / FLASH button to turn the LED light ON / OFF.

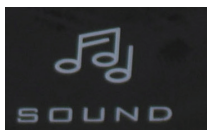

C) SOUND

Press the SOUND button to turn the sound ON / OFF.



D) BLOWER

Press the BLOWER button to turn the blower fan ON / OFF.



E) RESET

After the game is over, press the RESET button.

Press and hold the RESET button for 3 seconds to RESET the scorer at any time.

1-YEAR LIMITED WARRANTY

This product is warranted to the original purchaser to be free from defects in material or workmanship for a period of 1-Year from the date of the original retail purchase.

This warranty does not cover defects or damage due to improper installation, alteration, accident, or any other event beyond the control of the manufacturer. Defect or damage resulting from misuse, abuse, or negligence will void this warranty. This warranty does not cover scratching or damage that may result from normal usage.

This product is not intended for institutional or commercial use: the manufacturer does not assume any liability for such use. Institutional or commercial use will void this warranty.

This warranty is nontransferable and is expressly limited to the repair or replacement of the defective product. During the warranty period, the manufacturer shall repair or replace defective parts at no cost to the purchaser. Labor charges and related expenses for removal, installation or replacement of the product, or components are not covered under this warranty.

The manufacturer reserves the right to make substitutions to warranty claims if parts are unavailable or obsolete.

The manufacturer shall not be liable for loss of use of the product, or other consequential or incidental costs, expenses or damage incurred by the consumer of any other use.

All warranty claims must be made to Freetime Fun. A purchase receipt with purchase date will be required to process all warranty claims. The model number and part numbers found within the assembly instructions will be required when submitting any parts requests or warranty claims.

**BE SURE TO CHECK OUR WEBSITE AT FREETIMEFUN.COM
FOR GREAT NEW GAMES, SAUNAS, PATIO, AND POOL SUPPLIES FOR YOUR HOME AND FAMILY!
WWW.FREETIMEFUN.COM**



1830 E. FABYAN PKWY, BATAVIA, IL 60510
PHONE: 1-888-620-6088
EMAIL: CUSTOMERSERVICE@FREETIMEFUN.COM

TO ORDER REPLACEMENT PARTS
VISIT OUR WEBSITE
WWW.FREETIMEFUN.COM